



## ) EYE-LCD-8000-LE-500/-700

) eyeLCD  
EYES LCD LINE

### ) DISPLAY CHARACTERISTICS

- ) Professional 80-inch LCD monitor with Edge-LED backlight technology (ca. 203 cm)
- ) Two different brightness versions available (500 & 700 nits)
- ) Full HD Resolution (1920x1080px)
- ) Low installation depth, narrow bezel design
- ) Ideal for sophisticated applications in control room, conferencing or digital signage
- ) Metal standard housing (standard black RAL9005, different RAL colours available on request)
- ) Diverse Installation Possibilities (Portrait and Landscape possible)

### ) IMAGES



) Robust & slim design

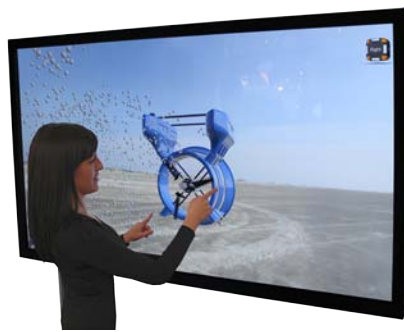

) Optional with touch surface



) Customised housing colours possible

### ) DIMENSIONS

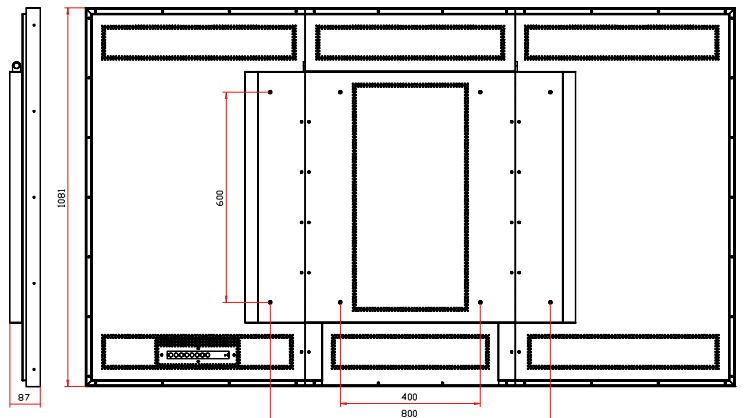
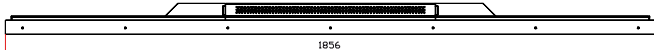
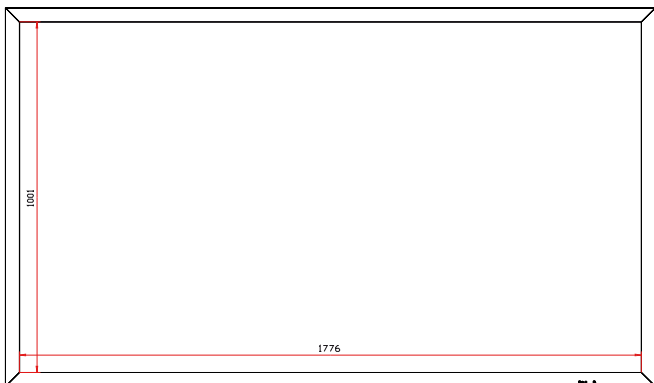

# ) EYE-LCD-8000-LE-500/700



## ) TECHNICAL SPECIFICATIONS

) LCD Screen	EYE-LCD-8000-LE-500	EYE-LCD-8000-LE-700
Backlight Technology:	Edge-LED	
Max. Image Resolution:	1,920 x 1,080 (full HD)	
Colours:	16.7M (8bits-true)	
Viewing Angle:	176° / 176° (H/V)	
Response Time:	4 ms	
Contrast Ratio:	5000:1	
Brightness:	typ. 500 cd/m <sup>2</sup> (min. 400 cd/m <sup>2</sup> )	typ. 700 cd/m <sup>2</sup> (min. 560 cd/m <sup>2</sup> )
Pixel Pitch:	0.9225 (H) x 0.9225 (V) mm	
24/7 Operation <sup>®</sup> :	Yes (recommended operation: 20/7)	
<b>) Connectors &amp; Control</b>		
Signal Connectors:	1x DVI / 2x HDMI / 1x VGA / 1x S-Video / 1x C-Video	
Audio:	2x Cinch / 2x MiniJack 3.5mm	
Control Interface:	RS232 (9-pin D-Sub), IR remote control, rear panel control buttons	
<b>) Power Supply</b>		
Input Voltage:	90-264V 50/60Hz; integrated mains adapter	
Power Consumption:	≤ 320W (typ.)	
<b>) Environmental</b>		
Operating Temperature:	0 – 40 °C	
Humidity:	max. 95%RH	
<b>) Mechanical</b>		
Screen Diagonal:	80 inch (ca. 203 cm)	
Screen Area:	1771.2 (H) x 996.3 (V)	
Dimensions (WxHxD):	1856 x 1081 x 87 mm	
Bezel:	ca. 40 mm (all sides)	
Weight:	approx. 78 kgs	
<b>) Options</b>		
Touch:	Optical touch surface with up to 32 simultaneous touch points	
Installations:	Different wallmounts and stands available	
Finishing:	Customised finishings available on request (standard colour black RAL9005)	
<b>) Order Information</b>		
Article Number:	0000017169	0000016995

<sup>®</sup>Electronic components designed for 24/7 operation. Prolonged display of static image contents may affect the display quality of the device. These effects do not affect the functionality of the device and are therefore not considered as defects in terms of our warranty conditions.



### eyevis GmbH

Hundsschleestr. 23 • 72766 Reutlingen • Germany  
 Phone: + 49 (0) 7121 43303 - 0 • Fax: + 49 (0) 7121 43303 - 22  
 www.eyevis.de • info@eyevis.de

As at: 21.05.2013/V1.4 • Subject to change!

All trademarks and registered trademarks are the property of their respective owners. Copyright © 2012 eyevis GmbH. All rights reserved.